

TG-800 Operating Instructions

Filling LEC: Using standard Butane Fuel, fill LEC as in picture A. Refer to instructions on LEC label. Allow fuel to stabilize before use (approx 5 minutes at room temperature).

Insert LEC into TG-800 LEC Chamber as in picture B making sure to insert with green flat side toward inside of Glue Gun.

Place glue stick in rear channel and push the glue stick all the way forward until it stops. If using short glue sticks, you may insert 2 glue sticks, one behind the next for continuous use. Advance the glue stick into heat chamber until it stops by pushing on the Glue Advance Lever "1"

Adjust Fuel Control "2" to mid or low setting. Note that the TG-800 has an automatic thermostatic control and it is not necessary to adjust the fuel control unless working in a very cold environment. The normal operating position should not be set higher than to a medium setting.

To start the fuel flow, push the "ON-OFF" sliding control "3" to the "ON" Position.

Ignite by pushing Ignition Button "4" You will see an orange glow through exhaust port "5". If there is no glow, push ignition button again. If there is no ignition but you hear a "spitting" sound, lower the Fuel Control to them MINIMUM position and re-ignite. TG-800 will be ready to use in approximately 2 minutes.

Dispense glue by gently advancing glue stick by gently squeezing the Glue Advance Lever "1" as above.

To turn off TG-800, simply move the "ON-OFF" control "3" to the OFF Position.

IMPORTANT: After turning off, dispense the remaining melted glue from the heat chamber.

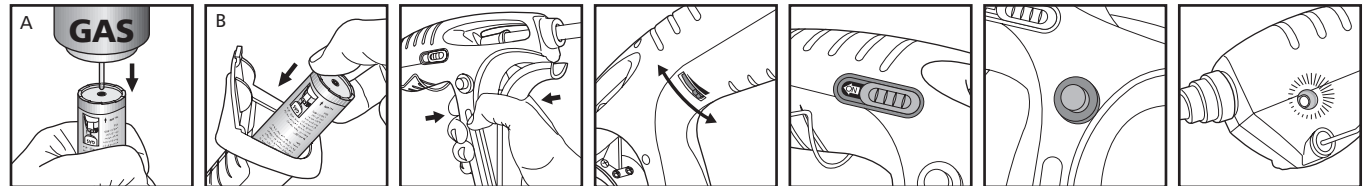

1. Glue Advance Lever

2. Fuel Control

3. "ON-OFF" sliding control

4. Ignition Button

5. exhaust port

NOTES:

- To avoid clogging and dripping after use, pull glue stick back approximately 1"
- When inserting a new glue stick during use, wait a few minutes for the glue to reach flow temperature
- If remaining glue stick is deep in the chamber and appears jammed, heat up end of a new glue stick, advance into chamber and gently pull out with a twisting motion.
- Fuel Control "2" should almost always be set to low-medium setting unless used in a very cold environment.
- When TG-800 is not in use for more than 10 minutes IT IS IMPORTANT to turn the unit off to prevent damage to the tool.

CAUTIONS:

- Remove LEC when TG-800 is not in use
- Keep Tool and LEC away from open flames or excessive heat
- Store tool and LEC out of direct sunlight or where temp may exceed 40°C/104°F
- Keep away from Children
- Always turn off TG-800 when not using for more than 5 minutes. Reignite to use and heat up time will be less than the initial use.
- Never use paste or liquid glues
- The glue heats up to 210°C Beware of Burns! Should you get glue on skin, immediately place affected area under cold water for some minutes. Do not try first to remove glue from skin. If necessary consult a doctor.
- Keep away from children
- Surfaces to be glued be dry, clean and free of grease.
- Glue drops are best removed when cold.
- Turn off TG-800 when not in use for more than 10 minutes. Leaving TG-800 on for long periods when not being used can cause damage to the tool.

TECHNICAL SPECIFICATIONS:

Length	240mm (9.4 in)
Height	195mm (7.7 in)
Weight (when gas-filled)	450 g
Temperature	145~210C/295~410F°
Gas container capacity	40 ml (LEC)
Operating capacity (one gas filling)	100 minutes

